

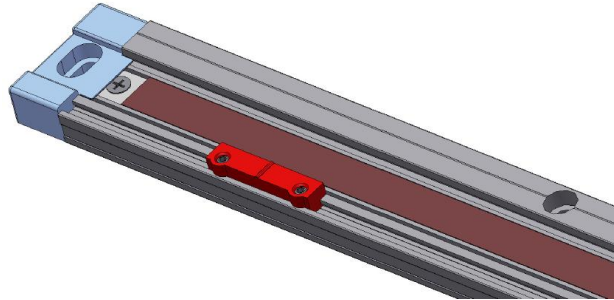

| | | | |
|----------------|---------------|----------|----------------------------|
| Code | Project | Release | Title |
| GVS 100 | GMPL01 | A | TECHNICAL DATASHEET |

GVS 100



- Scale Housing is anodized aluminium with cross section of 33 x 10 mm.
- End caps made of zamak mould: one end cap is designed to hold the tensioning mechanism in case the scale is a modular and other end cap on the fixed side.
- Stainless steel protection cover of the magnetic band to protect the band from external environment.

| MECHANICAL FEATURES | |
|----------------------------|---|
| Width | 33 mm |
| Thickness | 10 mm |
| Maximum length | 50 m |
| Thermal expansion | $10.5 \times 10^{-6} \text{ } ^\circ\text{C}^{-1}$ T ref.= 20°C ± 0.1°C |
| Operating temperature | 0° + 70°C |
| Storage temperature | -20° + 80°C |

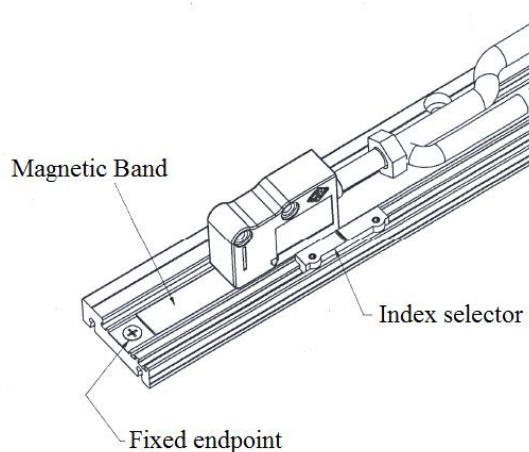

Incremental version : Possibility to mount the magnetic band with pole pitches 2 + 2 or 5 + 5, to be read by MTS sensors.

- Reference can be selectable or constant pitch. For selectable , the magneto set reference can be set at any position very easily along the extrusion in order to get the reference at that point.

For resolution, accuracy and for other characteristics please refer MTS and MP data sheets.

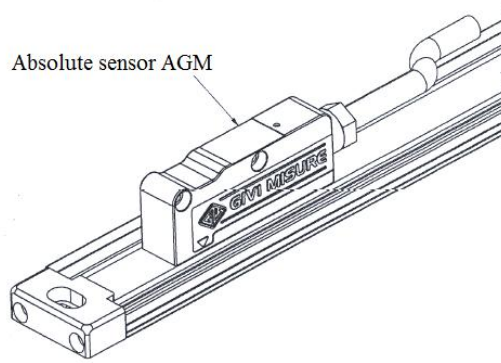

Absolute version : Magnetic band with pole pitch of 2 + 2, to be read by AGM sensor.

For resolution, accuracy and for other characteristics please refer MTS and MP data sheets.

Mounting characteristics :

Lengths from 0 to 1000 mm will be supplied in a single piece with magnetic band glued to the extrusion and mounting possibilities at the end caps and also at the extrusion.

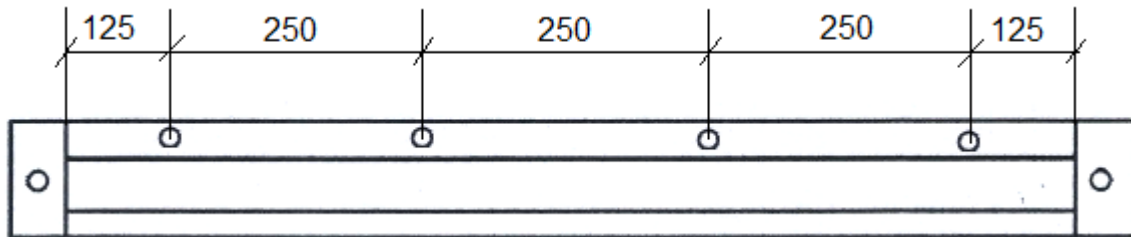

All dimensions in mm

Cross Section 33mm x 10mm

Lengths from 1000 and above which we call as modular version, the pieces will be supplied with segments above 1000 mm (exceeding part to the desired length). The magnetic band is not glued instead it will supplied in a roll form where the tensioning mechanism will be present at one end and tension will be given as the last step of the installation and commissioning process.

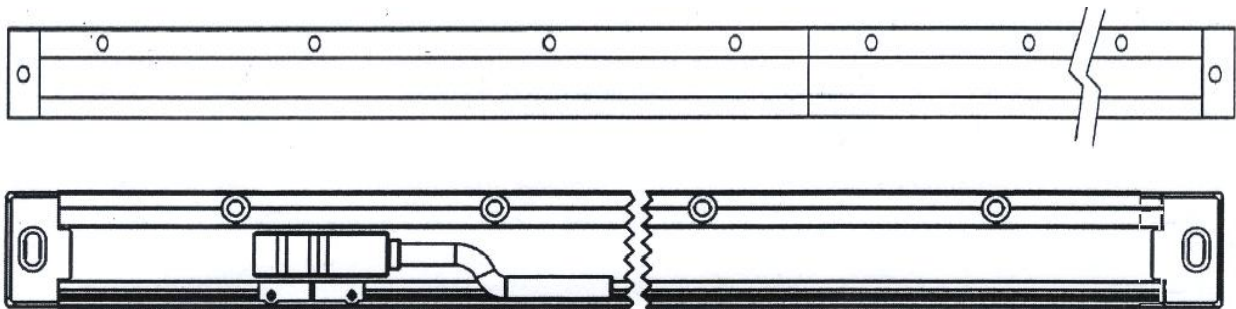

ORDERING CODE

| MODEL | MAGNETIC BAND TYPE | MAGNETIC SENSOR TYPE |
|---------|--------------------------|------------------------|
| GVS 100 | 2 | M |
| | 2 = MP 200 5 = MP 500 | M = MTS M H = MTS H |

Example ↪ GVS 100 2 M

INSTALLATION AND HANDLING

1. During installation , handle the extrusion with care.
2. The alignment tolerance for the scale should be within +/- 0.1 mm.
3. Keep other magnetic parts clear from the tape.
4. Store and roll up the magnetic tape keeping the magnetic strip on the outside in order to avoid tensions.
5. Provide the tension to the band using the 1mm allen key through the hole provided on the tensioning side end cap.

Without prior notice, the products may be subject to modifications that the Manufacturer reserves to introduce as deemed necessary for their improvement.